

Residential Fire Sprinkler Application Packet

These documents are ALL required and are part of the application process.

If you are unsure how to complete any of the forms, please contact our office at your earliest convenience.



The plans are required to be stamped by a WA State Engineer and must meet [NFPA 13 D](#) standards.

Submit 3 sets of stamped plans, 3 sets of hydraulic calculations, and 3 sets of product information.

Grant County Building Department
P O Box 37, Ephrata, WA 98823
(509) 754-2011 ext. 3001

Application # _____
This is not a permit - No work to begin until permit is issued
Please fill out form completely and legibly.

Applicant / Agent _____ phone _____

(Owner's designated agent / contact for application submittal, project and process related questions and correspondence. If Owner is applicant, fill out this section also.)

Mailing Addr/City/State/Zip _____

e-mail _____

Owner _____ phone _____

Mailing Addr/City/State/Zip _____

Are you currently listed as the legal owner of the land? Yes No If no, list current legal owner(s): _____
 Are you in the process of purchasing the land? Yes No _____
 Are you leasing the entire parcel of land? Yes No _____
 Are you leasing only a portion of the land or structure? Yes No _____

MH / Building owner (if different than land owner) _____ phone _____

General Contractor _____ phone _____

WA State Labor & Industries General Contracting license #: _____

Architect / Engineer / Designer _____ phone _____

Address of project site (if assigned by County) _____

Parcel #: _____ - _____ - _____ Acres _____ (or) Lot Dimensions _____ x _____

Legal Description: (May not all apply) FU _____ Block _____ S _____ T _____ R _____

Lot _____ Block _____ Subdivision Name / Phase # _____

Is this the only Building / Structure on this Parcel? Yes No Is this the only Residence (inclgd MH's) on this parcel? Yes No

Scope of Work: Residential Agriculture Commercial

Structure/add/alter FAS / MH Plumbing Mechanical Grading Demo Fire Marshal Other

Description: _____

Specific Use of Structure: _____

Footprint dimensions: _____ Peak Height: _____ Year of MH / Modular _____

Basement sq.ft. _____ Main/1st sq.ft. _____ 2nd floor sq.ft. _____ 3rd floor sq.ft. _____ Deck(s) sq.ft. _____

New Bedrooms _____ # New Bathrooms _____ Existing Bedrooms _____ Existing Bathrooms _____

I hereby apply for a permit to do the work shown above and attest that the information provided is correct. If I am not the legal land owner, I certify that I am submitting the application with the permission and authority of the landowner and have included the required Agent Authorization(s).

Signature of Applicant _____

Printed Name _____

Date _____

SITE PLAN INSTRUCTIONS

INSTRUCTIONS:

- A. Complete the information requested in the gray box at the top of the reverse side of this page and draw your site plan in the space provided; you may use additional 8½ X 11 sheets as needed;
- B. Identify the north arrow in the space provided;
- C. Use an accurate scale for drawing (ie; "1 inch = 10 feet" or "1 inch = 20 feet" or "1 inch = 100 feet" etc.);
- D. Draw the boundaries of the parcel including the dimensions (you may need a plat map copy from the assessors office)
- E. Draw the location and dimensions of all existing buildings and structures;
- F. Draw the location of the proposed project including the structure dimensions, and distances to property lines and existing buildings and structures;
- G. Draw the location of all proposed and existing utilities (including power, phone, water, sewer systems, reserve drainfield, etc.);
- H. Draw the location and dimensions of all existing and proposed roads, driveways, parking areas, rights-of-ways and easements;
- I. Draw the location of any distinguishing physical features located on or adjacent to the property (including but not limited to : streams, culverts, drainage ways, wetlands, slopes, bluffs, etc.);
- J. In the gray box at the bottom of the page, please provide detailed directions to the site;
- K. If you have questions regarding these instructions, please see the "EXAMPLE" SITE PLAN provided below. If you have further questions not covered in the example, please call (509) 754-2011, extension 620 for assistance.

"EXAMPLE" SITE PLAN

IN ORDER TO PROCESS LANDUSE APPLICATIONS, ALL SUBMISSIONS MUST INCLUDE A COMPLETED SITE PLAN MAP OF THE PROPOSED PROJECT (SEE INTRUCTIONS), submission of an incomplete site plan map will be considered as an incomplete application and returned to the applicant:

PROJECT/ OWNER NAME _____ DATE _____

PARCEL #(s) _____ DRAWING SCALE _____ inch(s) = _____ feet

NOTE: Please label all parcel boundaries with "Property Line"

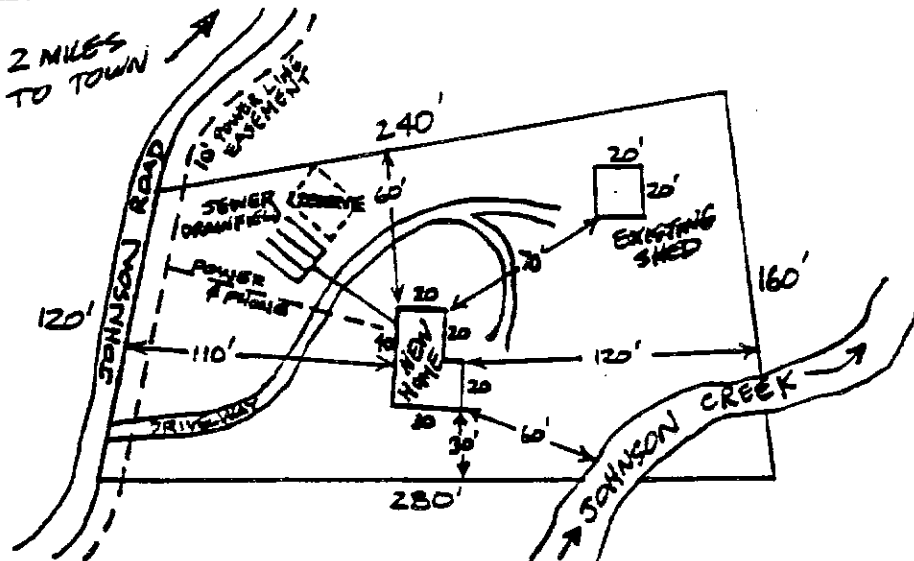

Directions to the Site:

IF YOU DON'T USE THE ATTACHED FORM, PLEASE BE SURE TO INCLUDE AN 8 ½ x 11 COPY OF YOUR SITE PLAN WITH YOUR BUILDING PERMIT APPLICATION PACKET.

SITE PLAN

IN ORDER TO PROCESS LANDUSE APPLICATIONS, ALL SUBMISSIONS MUST INCLUDE A COMPLETED SITE PLAN MAP OF THE PROPOSED PROJECT (SEE INSTRUCTIONS), submission of an incomplete site plan map will be considered as an incomplete application and returned to the applicant:

PROJECT/ OWNER NAME _____ DATE _____

PARCEL #(s) _____ DRAWING SCALE _____ inch(s) = _____ feet

NOTE: Please label all parcel boundaries with "*Property Line*"

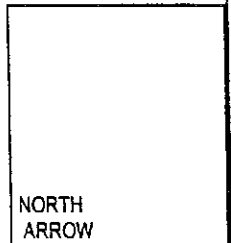

Directions to the Site: _____



Grant County
 Department of Building/Fire Marshal
 P O Box 37
 Ephrata WA 98823
 (509) 754-2011 ext. 3001

BUILDING PERMIT ACTIVITY - AUTHORIZATION FORM

As legal owner(s) of Parcel _____ - _____ - _____, I acknowledge and approve the request for Building Permit(s) for construction or installation of the **specific structures / work listed** below:

Further, I hereby authorize the following person(s) to act as my agent(s) regarding any activities involving the Application, and subsequent Permit, as noted above and filed with Grant County:

Name	Company	Relationship to Owner
------	---------	-----------------------

Name	Company	Relationship to Owner
------	---------	-----------------------

Name	Company	Relationship to Owner
------	---------	-----------------------

(For relationship to owner, be specific such as agent, contractor, tenant, co-owner, purchasing land, etc.)

Legal Owner Signature / Corporate Representative Signature

Legal Owner Signature / Corporate Representative Signature

Date

Date

Printed Name

Printed Name

Title and Company Name

Title and Company Name

As landowner, building owner and applicant for a Building Permit, if you want someone other than yourself to act as your agent, including contractors, engineers, architects, etc., you must complete this form and submit with each applicable application.

In cases of co-ownership, all legal owners must sign the form or attach additional forms.

Corporations and Trusts must have signature by at least one governing member or agent authorized to bind the corporation or trust.

This form may also be used for Tenants or other parties to authorize agents on their behalf.