



**THIS IS A SAMPLE GARAGE TO HELP  
YOU IDENTIFY THE ITEMS NEEDED  
FOR A PLAN REVIEW.**

***PLEASE PROVIDE ALL THE NECESSARY  
INFORMATION THAT PERTAINS TO  
YOUR PROJECT IN THE BLANKS  
PROVIDED ON HANDOUT.***

**YOUR PROJECT WILL BE**

**\_\_\_\_\_ X \_\_\_\_\_ X \_\_\_\_\_ ?  
(WIDTH) (LENGTH) (HEIGHT TO EAVE)**

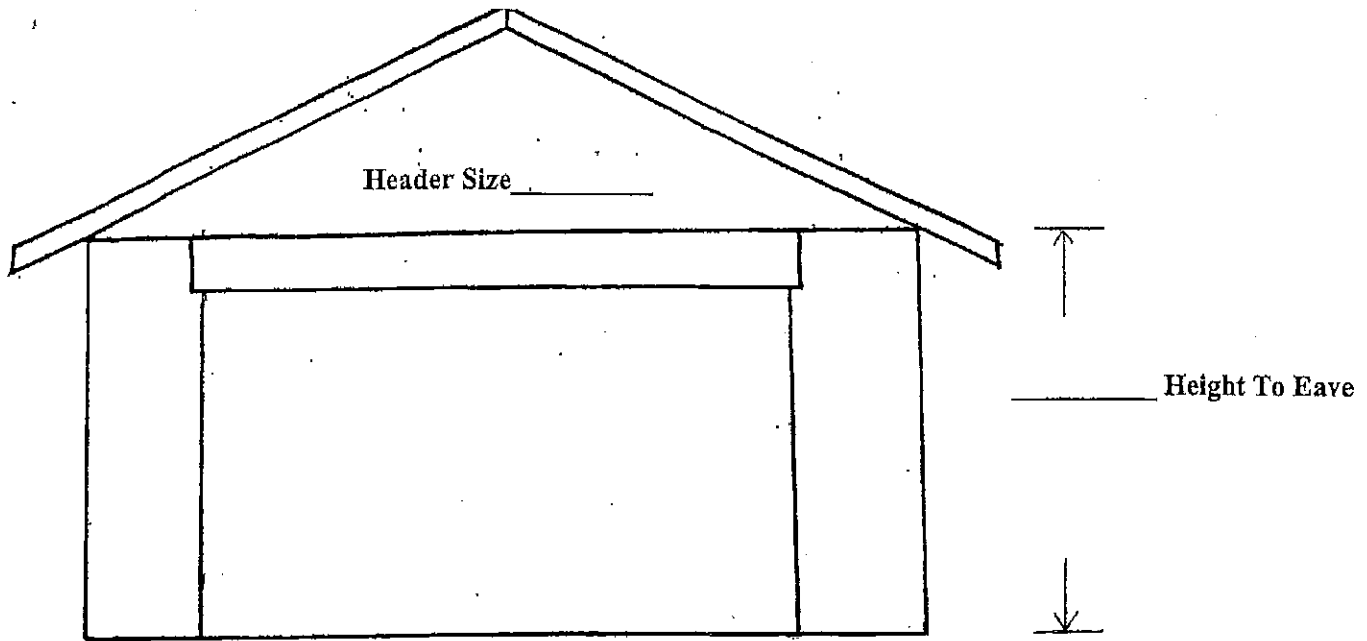

1. Give the width of the building
2. Give the length of the building
3. Give the height of the building
4. Show the direction of the roof system
5. Draw floor plan showing any interior rooms or plumbing
6. Clearly indicate where bracing shall occur
7. Show all window and door openings

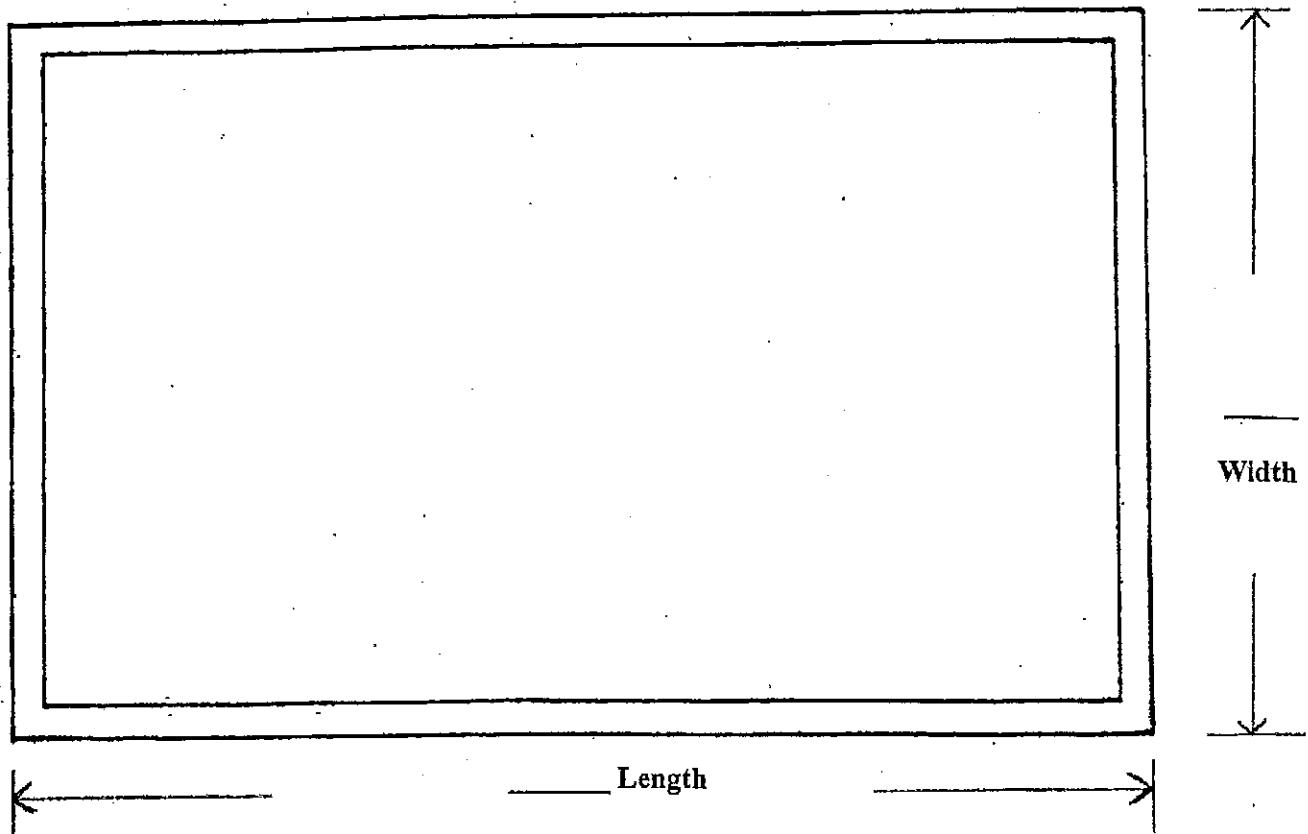

# TYPICAL GARAGE CROSS SECTION

If garage ceiling is finished, provide attic ventilation at 1/150 or 1/300 if 50% of venting occurs 36" above the plate line.

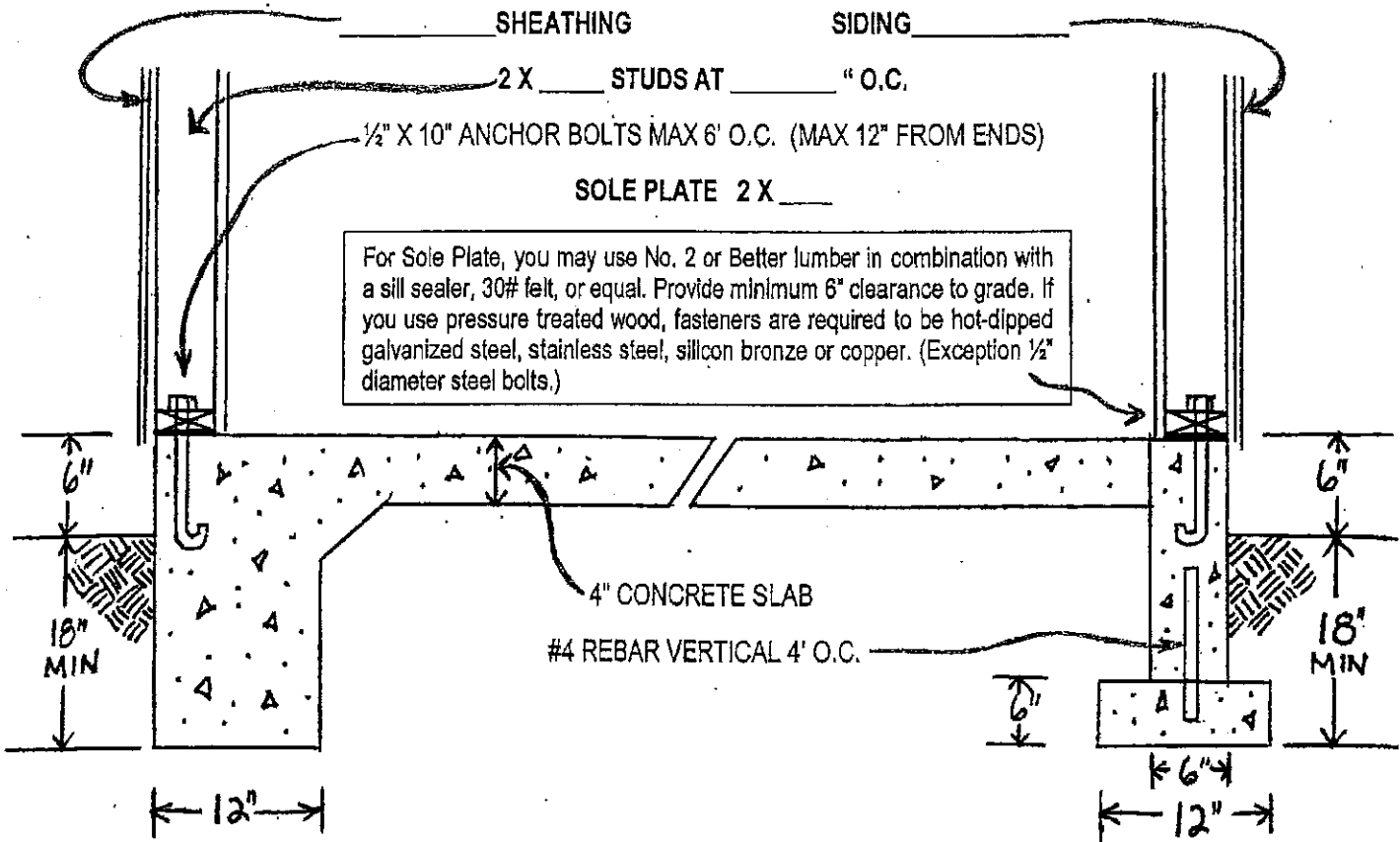
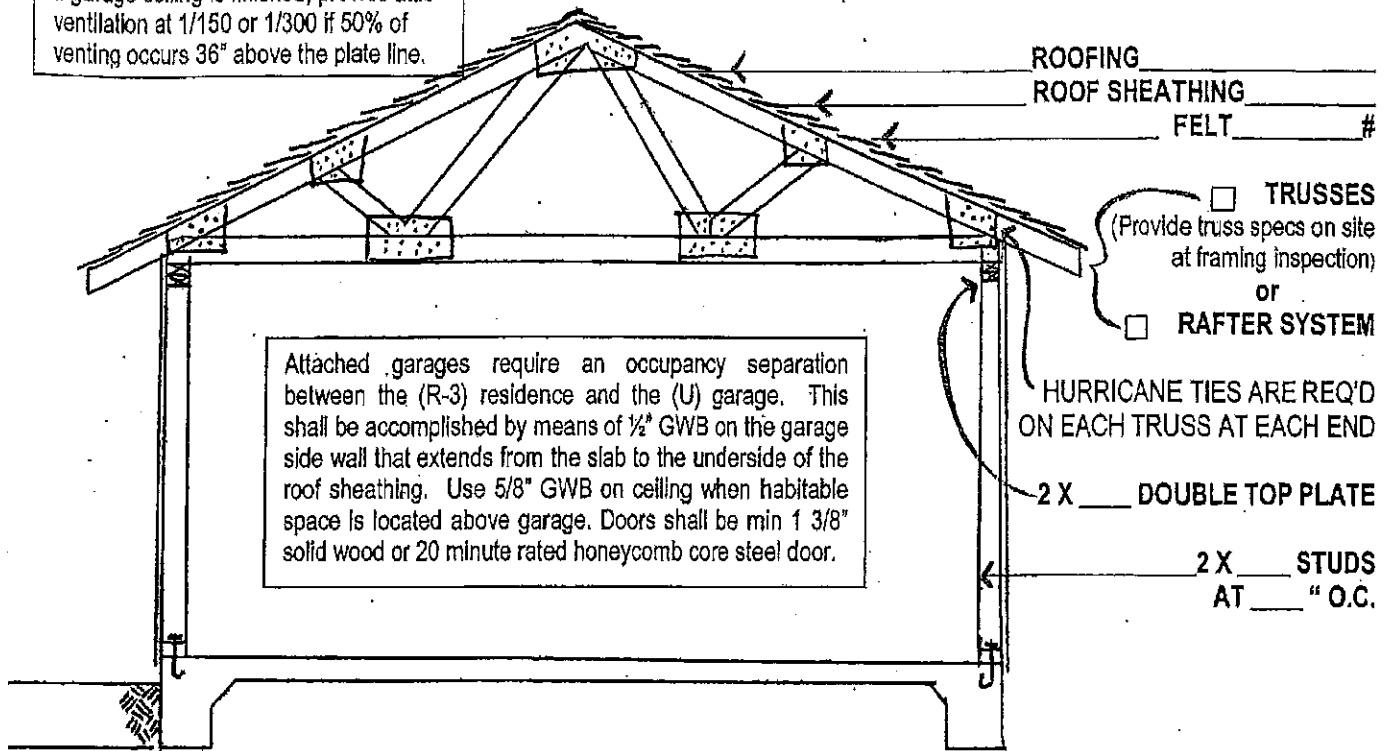

SINGLE POUR MONOLITHIC      OR       "T" STYLE STEMWALL & FOOTING

The following is a sample drawing only.

draw a floor plan specific to your building using practices shown below.

