

SITE PLAN INSTRUCTIONS

INSTRUCTIONS:

- Complete the information requested in the gray box at the top of the reverse side of this page and draw your site plan in the space provided; you may use additional 8½ X 11 sheets as needed;
- Identify the north arrow in the space provided;
- Use an accurate scale for drawing (ie; "1 inch = 10 feet" or "1 inch = 20 feet" or "1 inch = 100 feet" etc.);
- Draw the boundaries of the parcel including the dimensions (you may need a plat map copy from the assessors office)
- Draw the location and dimensions of all existing buildings and structures;
- Draw the location of the proposed project including the structure dimensions, and distances to property lines and existing buildings and structures;
- Draw the location of all proposed and existing utilities (including power, phone, water, sewer systems, reserve drainfield, etc.);
- Draw the location and dimensions of all existing and proposed roads, driveways, parking areas, rights-of-ways and easements;
- Draw the location of any distinguishing physical features located on or adjacent to the property (including but not limited to : streams, culverts, drainage ways, wetlands, slopes, bluffs, etc.);
- In the gray box at the bottom of the page, please provide detailed directions to the site;
- If you have questions regarding these instructions, please see the "EXAMPLE" SITE PLAN provided below. If you have further questions not covered in the example, please call (509) 754-2011, extension 620 for assistance.

"EXAMPLE" SITE PLAN

IN ORDER TO PROCESS LANDUSE APPLICATIONS, ALL SUBMISSIONS MUST INCLUDE A COMPLETED SITE PLAN MAP OF THE PROPOSED PROJECT (SEE INTRUCTIONS), submission of an incomplete site plan map will be considered as an incomplete application and returned to the applicant:

PROJECT/ OWNER NAME _____ DATE _____

PARCEL #(s) _____ DRAWING SCALE _____ inch(s) = _____ feet

NOTE: Please label all parcel boundaries with "Property Line"

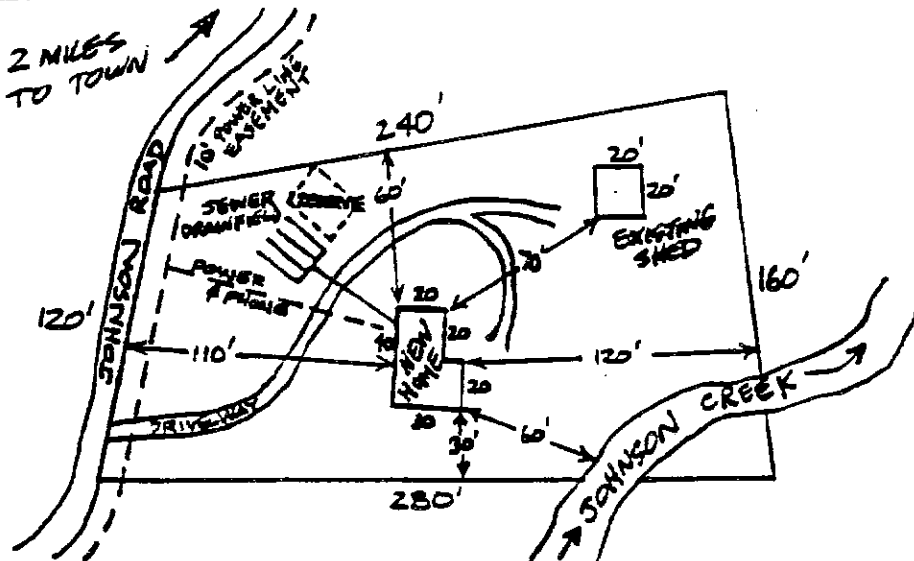

NORTH
ARROW

Directions to the Site:

IF YOU DON'T USE THE ATTACHED FORM, PLEASE BE SURE TO INCLUDE AN 8 ½ x 11 COPY OF YOUR SITE PLAN WITH YOUR BUILDING PERMIT APPLICATION PACKET.

SITE PLAN

IN ORDER TO PROCESS LANDUSE APPLICATIONS, ALL SUBMISSIONS MUST INCLUDE A COMPLETED SITE PLAN MAP OF THE PROPOSED PROJECT (SEE INSTRUCTIONS), submission of an incomplete site plan map will be considered as an incomplete application and returned to the applicant:

PROJECT/ OWNER NAME _____ DATE _____

PARCEL #(s) _____ DRAWING SCALE _____ inch(s) = _____ feet

NOTE: Please label all parcel boundaries with "*Property Line*"

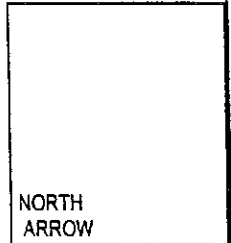

Directions to the Site: _____

